

A = Caricamento acqua - Water inlet
 B = Allacciamento elettrico - Electric connection
 C = Scarico - Drain

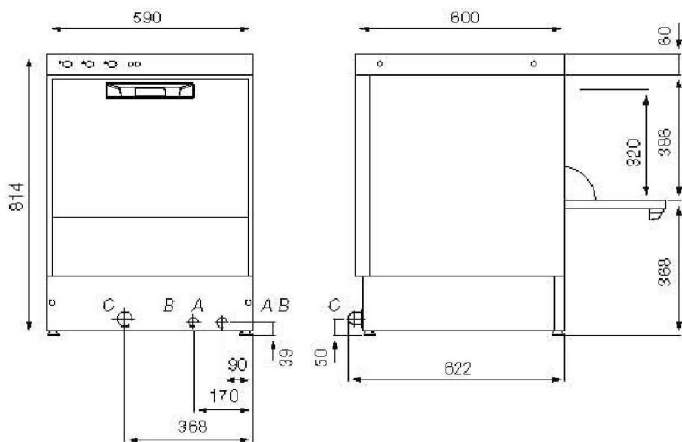

Dotazione
Included item

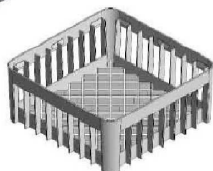

nr. 1
Cesto Bicchieri
Basket for Glasses



nr. 1
Cesto Piatti
Basket for dishes

Dotazione
Included item

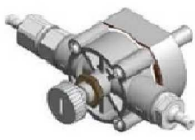

Dosatore Brillantante
Rinse-aid dispenser

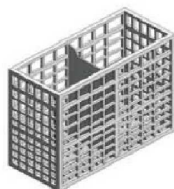

nr. 2
Inserto porta posate
Cutlery insert

Opzioni
Optional item



Inserto 22 piatti
Insert 22 plates



Piedistallo
Stand



CARATTERISTICHE TECNICHE
TECHNICAL DATA

Alimentazione Elettrica Electric supply	1 x 230V 50 Hz
Assorbimento pompa lavaggio Wash pump absorption	Kw 0,75 1HP
Resistenza boiler Boiler element	W 2700
Resistenza vasca Tank element	W 2200
Potenza massima assorbita Total power rating	W 3450
Capacità vasca Wash Tank capacity	lt. 28
Capacità boiler Boiler capacity	lt. 6
Temperatura lavaggio/risciacquo Wash/rinse temperature	55°/85°C
Durata ciclo Cycle timer	120 sec.
Pressione alimentazione Required water pressure	bar 2 ÷ 4
Diam. tubo carico/scarico Water supply hose	3/4" 31mm
Peso netto Net weight	Kg. 50

IME s.r.l. Via Brenno, 21 - 20853 Biassono (MB) - Italy
 Tel. (+39) 039.47.01.13 - Fax (+39) 039.47.01.20 - comm@imesrl.com

www.omniwash.eu

